



Product Catalogue

R•FIX

ABOUT THE COMPANY

Radius Fixings OÜ (R-FIX) was founded in 2010, and, since then, it has developed into a professional manufacturer of fixing accessories. Our mission is to help architects and construction professionals create luminous and airy buildings by providing secure fixing solutions.

The warehouse for R-FIX's standard products is located in the small town of Kiili, 15 km from Tallinn. We keep sufficient stock of all our catalogue products in order to offer fast and stable deliveries. As we manufacture the products ourselves, we can offer various custom-made sets of parts suitable just for your applications and direct from our facility.



In addition to our warehouse products, we also offer project-specific special solutions. For this purpose, we design our products according to the requirements set in the design documentation, perform strength analyses for glass and metal, and manufacture high quality parts within the time constraints. When necessary, we perform load tests for our products in the laboratory.

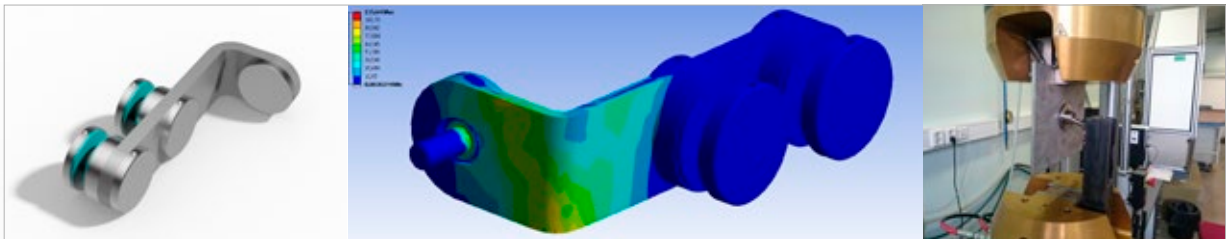

In terms of production technology, we mainly use CNC turning and milling, laser cutting, welding and different surface finishing techniques. The most used materials are stainless steel types 304 (EN 1.4301) and 316 (EN 1.4404) as well as aluminium type 6063-T6. As glass seals, we use different UV-resistant plastics and rubber.



Since 2013, we have held a factory production control conformity certificate issued by Inspecta, which gives us the right to mark our products with a CE-marking.



CONTENT

	Page
Full glass boundary system GP	 5
Handrail on the glass	 9
Baluster posts	 11
Glass Clamps	 15
Post and handrail accessories	 17
Point fixings for glass	 25
Glass canopy system RC	 33
Tension rod system TR	 37
Point fixed SG-facade	 41



Ülemiste Centre, Tallinn - full glass boundary system GP



Full glass boundary system GP

Minimalistic glass boundary system



- Maximum load resistance of the boundary 1.5 kN/m
- Profile measures 60 x 110 mm
- Aesthetic surface finishing: brushed stainless steel effect
- Profile to be provided with milled fastening openings with spacing 200 mm
- Standard profile length 3000 mm
- Glass thickness (mm): 10; 12; 13.5; 17.5; 19.5; 21.5
- Fast fastening of glass panes with plastic wedges and special tool.
- The profile is also available in powder coated and/or bended form.

System components

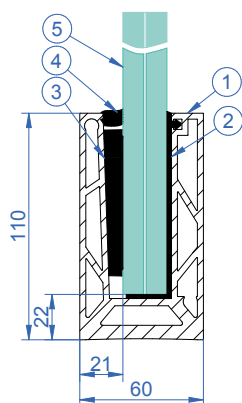

- 1 Aluminium profile
- 2 Rubber gasket supporting the glass pane
- 3 Two-component plastic wedge
- 4 Rubber gasket covering the wedges
- 5 Glass pane

System fastened in the bottom GP1

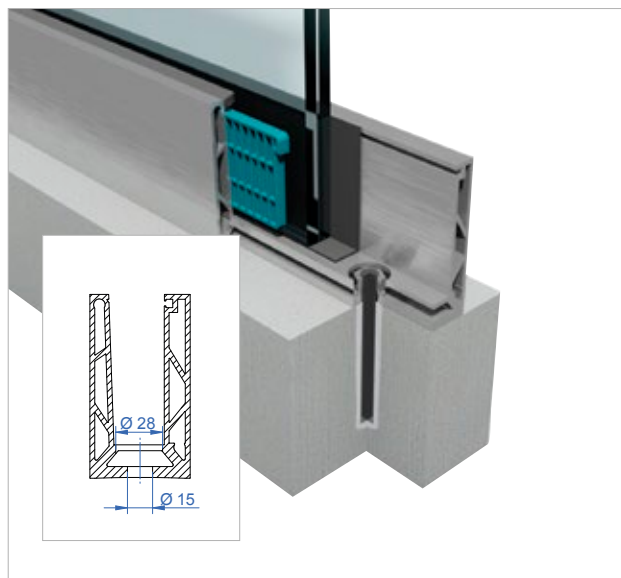

System fastened on the sides GP2

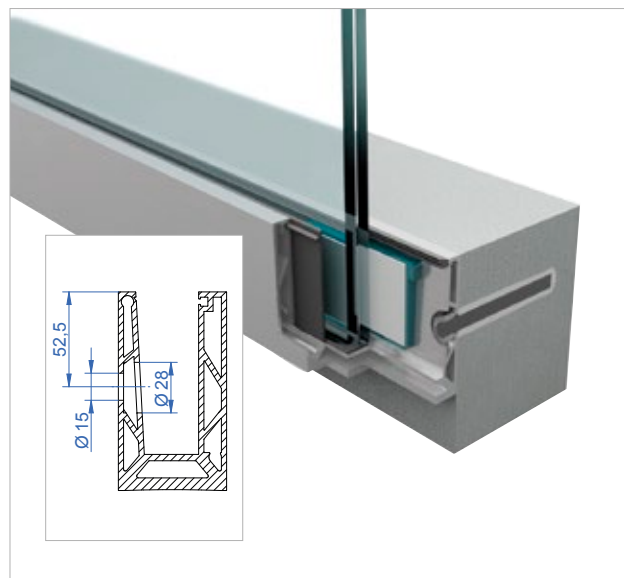

Required fastening fixtures

- Chemical anchor + M12 threaded rod (strength 8.8)
- M12 wedge anchor

Profile fastening spacing

- 0,5 kN/m boundary – 400 mm
- 1 kN/m boundary – 200 mm
- 1,5 kN/m boundary – 200 mm

GP full glass boundary system sets, length 3 m

Code	Fixing method	Surface finishing	Glass thickness
GP1.10	Base fixed	Anodised, brushed stainless steel effect	10 mm
GP1.12	Base fixed	Anodised, brushed stainless steel effect	12 mm
GP1.128	Base fixed	Anodised, brushed stainless steel effect	12.76 mm (66.2 lam.)
GP1.135	Base fixed	Anodised, brushed stainless steel effect	13.52 mm (66.4 lam.)
GP1.168	Base fixed	Anodised, brushed stainless steel effect	16.76 mm (88.2 lam.)
GP1.175	Base fixed	Anodised, brushed stainless steel effect	17.52 mm (88.4 lam.)
GP1.195	Base fixed	Anodised, brushed stainless steel effect	19.52 mm (108.4 lam.)
GP1.208	Base fixed	Anodised, brushed stainless steel effect	20.76 mm (1010.2 lam.)
GP1.215	Base fixed	Anodised, brushed stainless steel effect	21.52 mm (1010.4 lam.)

Code	Fixing method	Surface finishing	Glass thickness
GP1R.10	Base fixed	Raw aluminium	10 mm
GP1R.12	Base fixed	Raw aluminium	12 mm
GP1R.128	Base fixed	Raw aluminium	12.76 mm (66.2 lam.)
GP1R.135	Base fixed	Raw aluminium	13.52 mm (66.4 lam.)
GP1R.168	Base fixed	Raw aluminium	16.76 mm (88.2 lam.)
GP1R.175	Base fixed	Raw aluminium	17.52 mm (88.4 lam.)
GP1R.195	Base fixed	Raw aluminium	19.52 mm (108.4 lam.)
GP1R.208	Base fixed	Raw aluminium	20.76 mm (1010.2 lam.)
GP1R.215	Base fixed	Raw aluminium	21.52 mm (1010.4 lam.)

Code	Fixing method	Surface finishing	Glass thickness
GP2.10	Side fixed	Anodised, brushed stainless steel effect	10 mm
GP2.12	Side fixed	Anodised, brushed stainless steel effect	12 mm
GP2.128	Side fixed	Anodised, brushed stainless steel effect	12.76 mm (66.2 lam.)
GP2.135	Side fixed	Anodised, brushed stainless steel effect	13.52 mm (66.4 lam.)
GP2.168	Side fixed	Anodised, brushed stainless steel effect	16.76 mm (88.2 lam.)
GP2.175	Side fixed	Anodised, brushed stainless steel effect	17.52 mm (88.4 lam.)
GP2.195	Side fixed	Anodised, brushed stainless steel effect	19.52 mm (108.4 lam.)
GP2.208	Side fixed	Anodised, brushed stainless steel effect	20.76 mm (1010.2 lam.)
GP2.215	Side fixed	Anodised, brushed stainless steel effect	21.52 mm (1010.4 lam.)

Code	Fixing method	Surface finishing	Glass thickness
GP2R.10	Side fixed	Raw aluminium	10 mm
GP2R.12	Side fixed	Raw aluminium	12 mm
GP2R.128	Side fixed	Raw aluminium	12.76 mm (66.2 lam.)
GP2R.135	Side fixed	Raw aluminium	13.52 mm (66.4 lam.)
GP2R.168	Side fixed	Raw aluminium	16.76 mm (88.2 lam.)
GP2R.175	Side fixed	Raw aluminium	17.52 mm (88.4 lam.)
GP2R.195	Side fixed	Raw aluminium	19.52 mm (108.4 lam.)
GP2R.208	Side fixed	Raw aluminium	20.76 mm (1010.2 lam.)
GP2R.215	Side fixed	Raw aluminium	21.52 mm (1010.4 lam.)

The set contains: 3 m aluminium profile, rubber seals and plastic wedges.

Accessories

Profile end plate



Code	Height H	Material
GPD.EC	110	Brushed stainless steel
GPD.ECS	155	Brushed stainless steel

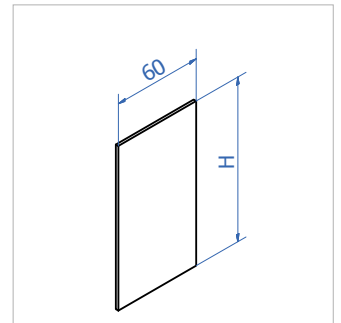

Profile connection dowel



Code	Material
GPD.DO	Brushed stainless steel

INFO: It is necessary to use 2 connection dowels for each connection point.

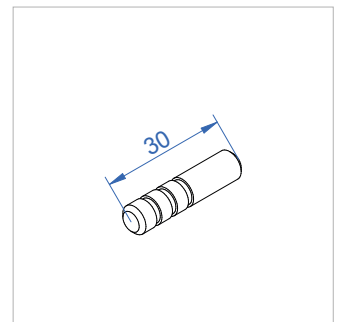

Tool for installing / removing wedges



Code
GPD.TOOL

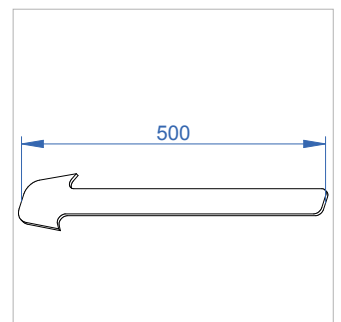

U-profile, to be glued onto the glass, length 2.5 m



Code	A	B	C
GPD.U135	13.6	15.6	15
GPD.U175	17.6	19.6	19
GPD.U215	21.6	23.6	23

Material: brushed stainless steel

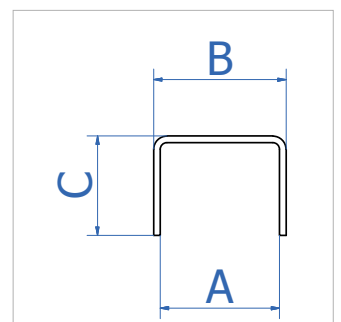

Handrail onto the glass

Ø42.4x1.5 slot tube



Code	Material
HRDS424.304	304
HRDS424.316	316

INFO: Surface finishing: brushed

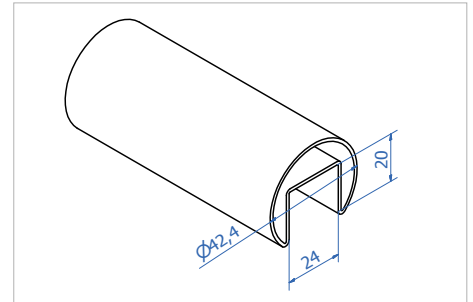

Rubber seals for Ø42.4x1.5 slot tube



Code	Glass thickness
HRDS.R12	12-13.5 mm
HRDS.R16	16-17.5 mm
HRDS.R20	20-21.5 mm

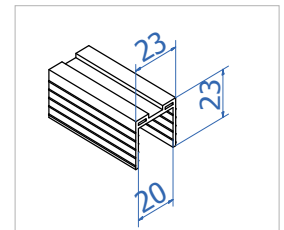
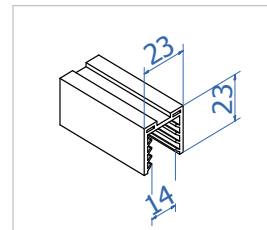
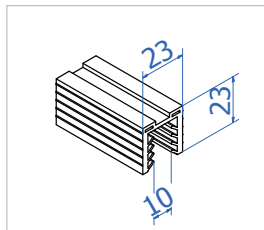

Ø42.4x1.5 connector 180° for slot tube



Code	Material
HRDS.EG215	316

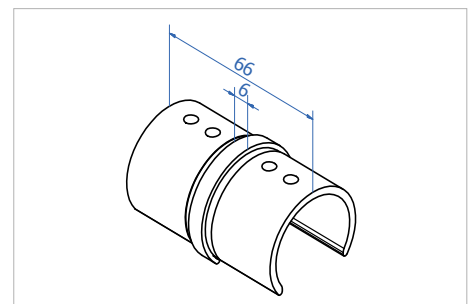

INFO: Use the glue HR.GLUE

Ø42.4x1.5 connector 90° for slot tube



Code	Material
HRDS.EG115	316

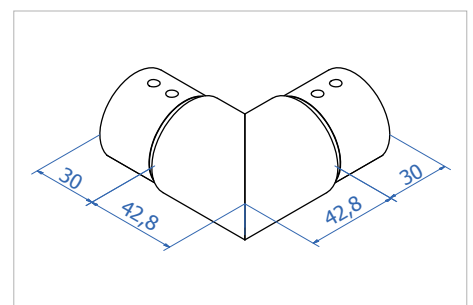

INFO: Use the glue HR.GLUE

Handrail onto the glass

Ø42.4x1.5 slot tube connector for the stair rise, upper



Code	Material
HRDS.EG815	316

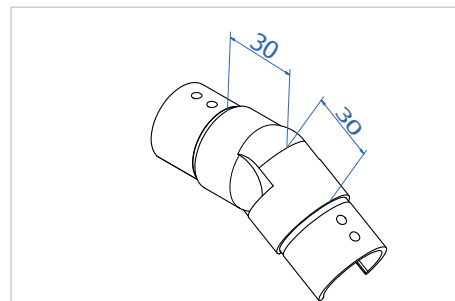

INFO: Use the glue HR.GLUE

Ø42.4x1.5 slot tube connector for the stair rise, lower



Code	Material
HRDS.EG915	316

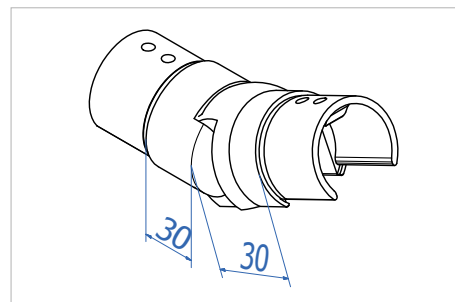

INFO: Use the glue HR.GLUE

Ø42.4x1.5 slot tube wall flange



Code	Material
HRDS.EG515	316

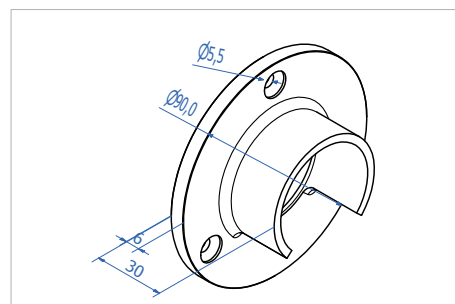

Ø42.4x1.5 slot tube end cap



Code	Material
HRDS.EG315	316

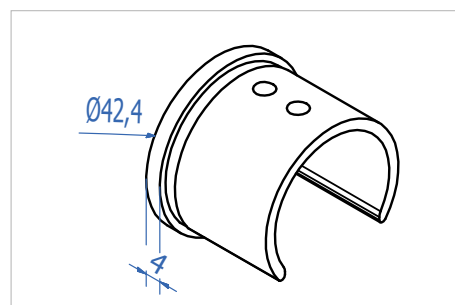

INFO: Use the glue HR.GLUE



Baluster posts and accessories

Baluster posts

Base fixed baluster post Ø42.4x2



Code	Material
SPB42.04	304
SPB42.16	316

INFO: Surface finishing: brushed
 Supplied with the base cover HRBC015
 Possible to manufacture posts of different length

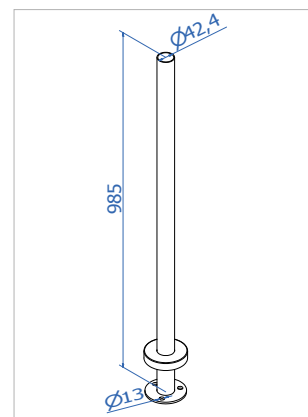

Base Ø100x6 mm

Base fixed baluster post 40x40x2



Code	Material
SPB40.04	304
SPB40.16	316

INFO: Surface finishing: brushed
 Supplied with the base cover HRBC115
 Possible to manufacture posts of different length

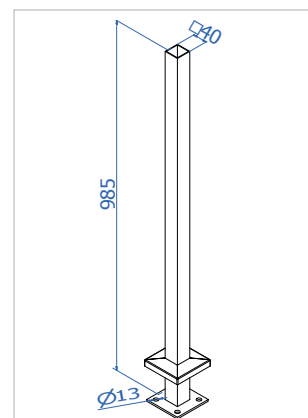

Base 100x100x6 mm

Side fixed baluster post Ø42.4x2



Code	Material
SPS42.04	304
SPS42.16	316

INFO: Surface finishing: brushed
 Supplied with lower end cap HRC220 and side fixing accessories for the post, incl. M8x140 stud bolt or M8x120 wood bolt
 The package contains the post in unassembled state.
 Possible to manufacture posts of different length.

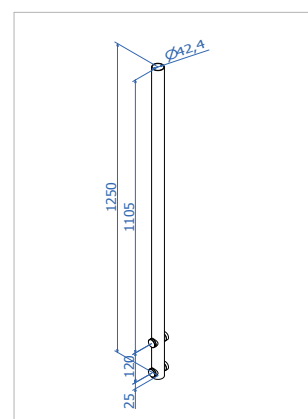

Side fixed baluster post 40x40x2



Code	Material
SPS40.04	304
SPS40.16	316

INFO: Surface finishing: brushed
 Supplied with lower end cap HRC1220 and side fixing accessories for the post, incl. M8x140 stud bolt or M8x120 wood bolt
 The package contains the post in unassembled state.
 Possible to manufacture posts of different length.

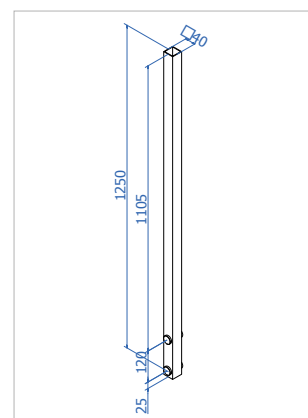

Baluster posts

Base fixed baluster post Ø42.4x2



Code	Material	Description
SPB42.04.4	304	4 clamps GC12.S4
SPB42.04.2	304	2 clamps GC12.S4
SPB42.16.4	316	4 clamps GC12.S16
SPB42.16.2	316	2 clamps GC12.S16
SPB42.ZS.4	304+zamak	4 clamps GC12.ZS
SPB42.ZS.2	304+zamak	2 clamps GC12.ZS

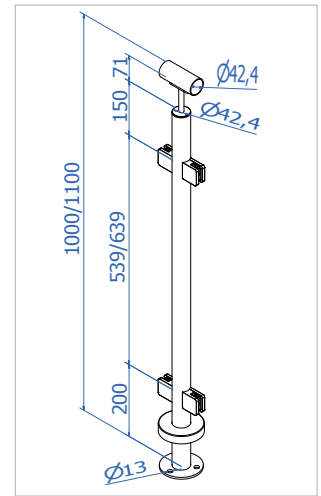

Base Ø100x6 mm

INFO: Surface finishing: brushed

Supplied with:

- handrail bracket HR400/500/600/700
- base cover HRBC015
- glass clamps

The package contains the post in unassembled state

The set does not include glue for fixing the handrail bracket

Possible to manufacture posts of different length

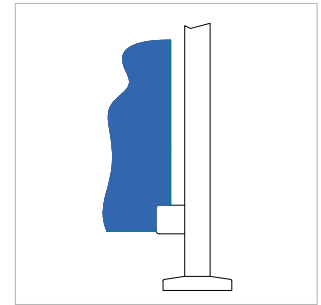
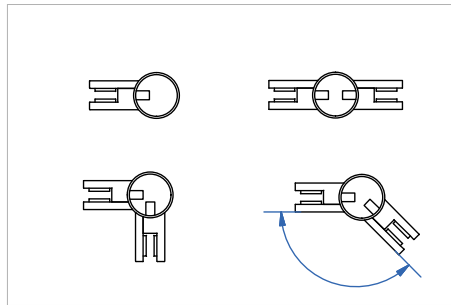

Alternative with safety plate

Base fixed baluster post 40x40x2



Code	Material	Description
SPB40.04.4	304	4 clamps GC11.S4
SPB40.04.2	304	2 clamps GC11.S4
SPB40.16.4	316	4 clamps GC11.S16
SPB40.16.2	316	2 clamps GC11.S16
SPB40.ZS.4	304+zamak	4 clamps GC11.ZS
SPB40.ZS.2	304+zamak	2 clamps GC11.ZS

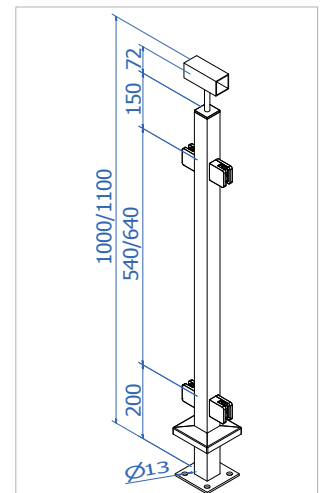

Base 100x100x6 mm

INFO: Surface finishing: brushed

Supplied with:

- handrail bracket HR410/510/610/710
- base cover HRBC115
- glass clamps

The package contains the post in unassembled state

The set does not include glue for fixing the handrail bracket

Possible to manufacture posts of different length

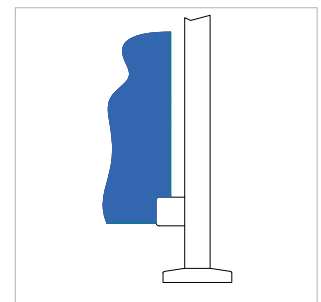
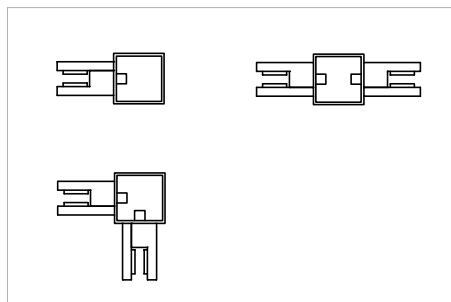

Alternative with safety plate

Baluster posts

Side fixed baluster post Ø42.4x2



Code	Material	Description
SPS42.04.4	304	4 clamps GC12.S4
SPS42.04.2	304	2 clamps GC12.S4
SPS42.16.4	316	4 clamps GC12.S16
SPS42.16.2	316	2 clamps GC12.S16
SPS42.ZS.4	304+zamak	4 clamps GC12.ZS
SPS42.ZS.2	304+zamak	2 clamps GC12.ZS

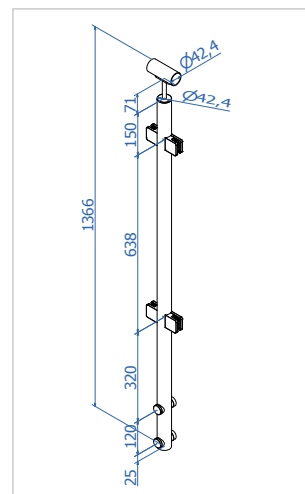

INFO: Surface finishing: brushed

Supplied with:

- handrail bracket HR400/500/600/700
- side fixing accessories for the post, incl. M8x140 stud bolt or M8x120 wood bolt
- glass clamps

The package contains the post in unassembled state

The set does not include glue for fixing the handrail bracket

Possible to manufacture posts of different length

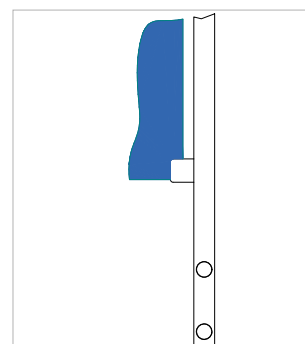
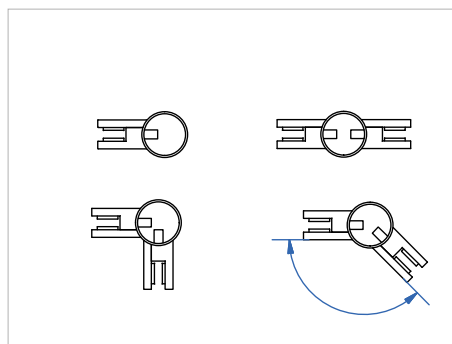

Alternative with safety plate

Side fixed baluster post 40x40x2



Code	Material	Description
SPS40.04.4	304	4 clamps GC11.S4
SPS40.04.2	304	2 clamps GC11.S4
SPS40.16.4	316	4 clamps GC11.S16
SPS40.16.2	316	2 clamps GC11.S16
SPS40.ZS.4	304+zamak	4 clamps GC11.ZS
SPS40.ZS.2	304+zamak	2 clamps GC11.ZS

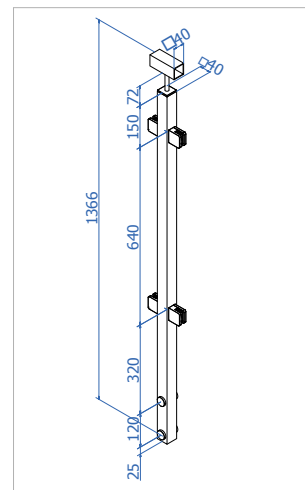

INFO: Surface finishing: brushed

Supplied with:

- handrail bracket HR410/510/610/710
- side fixing accessories for the post, incl. M8x140 stud bolt or M8x120 wood bolt
- glass clamps

The package contains the post in unassembled state

The set does not include glue for fixing the handrail bracket

Possible to manufacture posts of different length

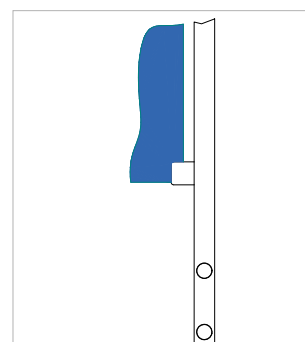
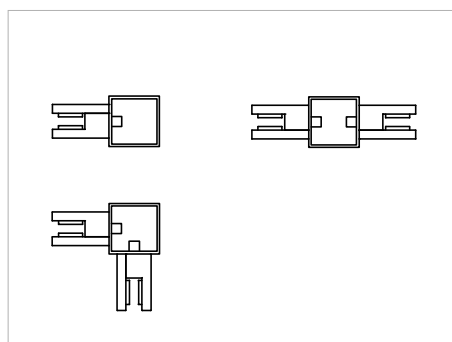

Alternative with safety plate

Glass clamps

Glass clamp GC11



Code	Dimensions	Material
GC11.S4	45x45 mm	304
GC11.S16	45x45 mm	316
GC11.ZS	45x45 mm	zamak, SS-effect
GC11.ZR	45x45 mm	zamak, raw

INFO: Possibility of a safety plate

The set includes glass seals and a safety pin

Glass thickness: 6; 8; 8.76; 10; 10.76 mm

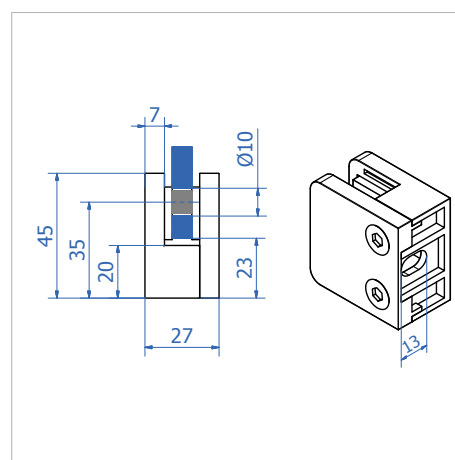

Glass clamp GC12



Code	Dimensions	Material
GC12.S4	45x45 mm	304
GC12.S16	45x45 mm	316
GC12.ZS	45x45 mm	zamak, SS-effect
GC12.ZR	45x45 mm	zamak, raw

INFO: Possibility of a safety plate

The set includes glass seals and a safety pin

Glass thickness: 6; 8; 8.76; 10; 10.76 mm

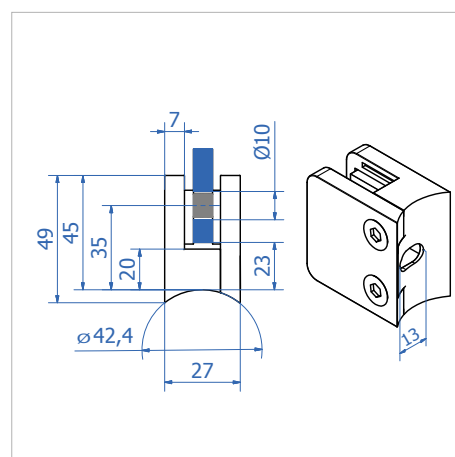

Safety plate for clamps GC11 and GC12



Code	Material
GCP.S16	316
GCP.ZS	zamak, SS-effect
GCP.ZR	zamak, raw

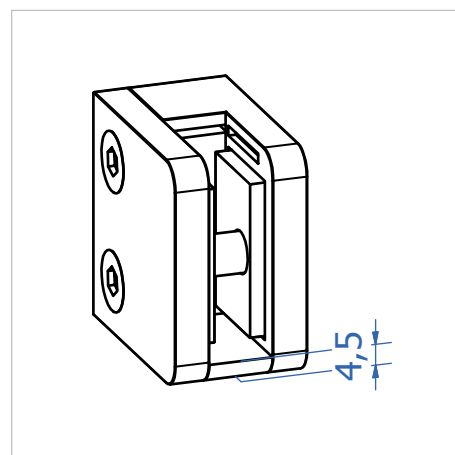

Glass clamps

Glass clamp GC21



Code	Dimensions	Material
GC21.S4	50x40 mm	304
GC21.S16	50x40 mm	316
GC21.ZS	50x40 mm	zamak, SS-effect
GC21.ZR	50x40 mm	zamak, raw

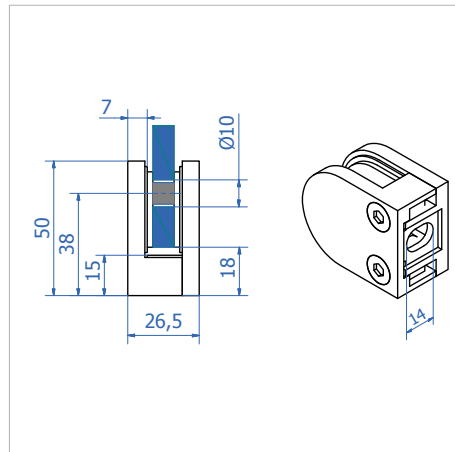

INFO:

The set includes glass seals and a safety pin

Glass thickness: 6; 8; 8.76; 10; 10.76 mm

Glass clamp GC22



Code	Dimensions	Material
GC22.S4	50x40 mm	304
GC22.S16	50x40 mm	316
GC22.ZS	50x40 mm	zamak, SS-effect
GC22.ZR	50x40 mm	zamak, raw

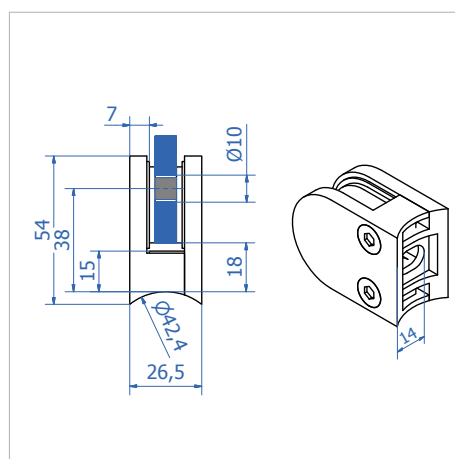

INFO:

The set includes glass seals and a safety pin

Glass thickness: 6; 8; 8.76; 10; 10.76 mm

Handrail brackets

Handrail bracket for the wall, M8 thread



Code	Material	Saddle for handrail
HR1200	316	-
HR1200.00	316	Flat
HR1200.42	316	Round Ø42.4

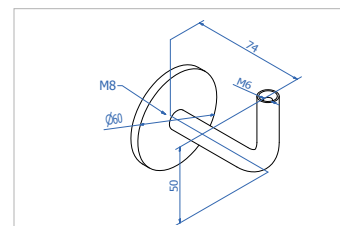

HR 1200

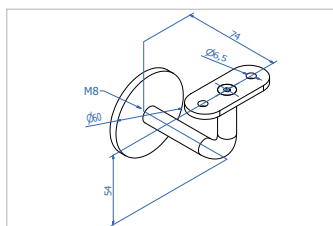

HR 1200.00

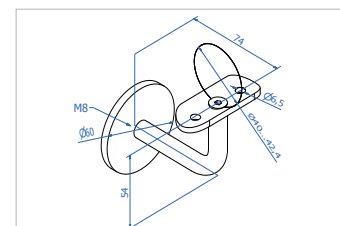

HR 1200.42

Handrail bracket for the wall, 3 screw holes



Code	Material	Saddle for handrail
HR1600	316	-
HR1600.00	316	Flat
HR1600.42	316	Round Ø42.4

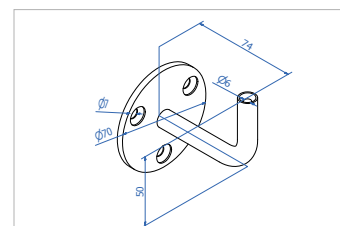

HR 1600

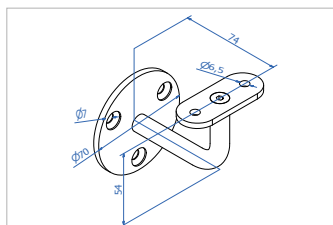

HR 1600.00

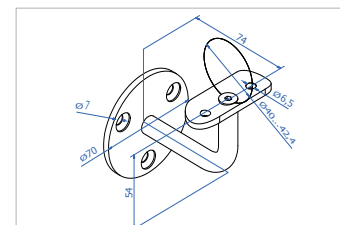

HR 1600.42

Handrail bracket for the glass



Code	Material	Saddle for handrail
HR1300	316	-
HR1300.00	316	Flat
HR1300.42	316	Round Ø42.4

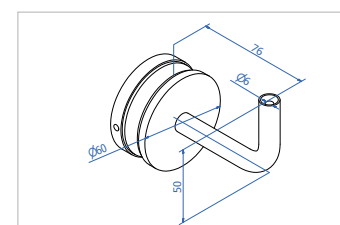

HR 1300

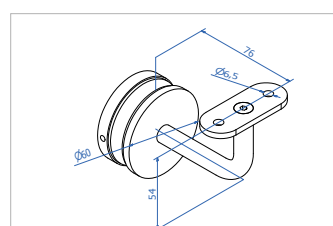

HR 1300.00

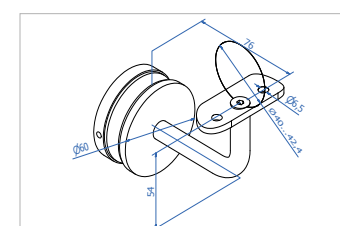

HR 1300.42

Handrail brackets

Handrail bracket for the post Ø42.4x2



Code	Material	Saddle for handrail
HR400.00	316	Flat
HR400.42	316	Round Ø42.4

INFO: Use the glue HR.GLUE

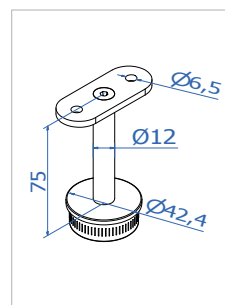

HR 400.00

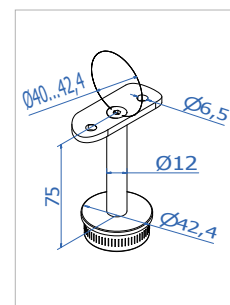

HR 400.42

Handrail bracket for the post Ø42.4x2



Code	Material	Saddle for handrail
HR500.00	316	Flat
HR500.42	316	Round Ø42.4

INFO: Use the glue HR.GLUE

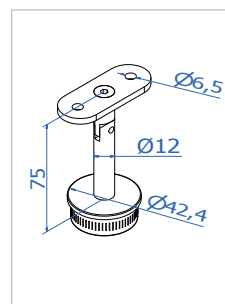

HR 500.00

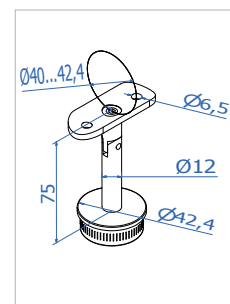

HR 500.42

Handrail bracket for the post Ø42.4x2



Code	Material	Saddle for handrail
HR600.00	316	Flat
HR600.42	316	Round Ø42.4

INFO: Use the glue HR.GLUE

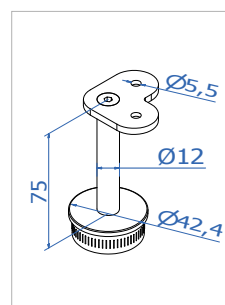

HR 600.00

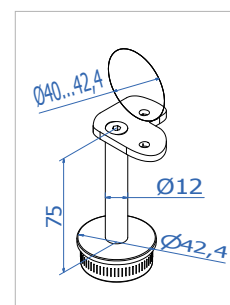

HR 600.42

Handrail bracket for the post Ø42.4x2



Code	Material	Saddle for handrail
HR700.00	316	Flat
HR700.42	316	Round Ø42.4

INFO: Use the glue HR.GLUE

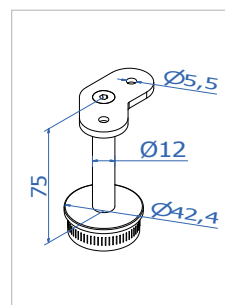

HR 700.00

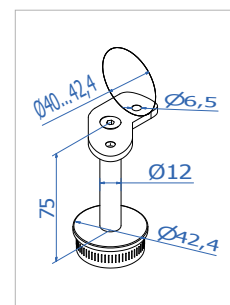

HR 700.42

Handrail brackets

Handrail bracket for the post 40x40x2



Code	Material	Saddle for handrail
HR410.00	316	Flat
HR410.42	316	Round Ø42.4

INFO: Use the glue HR.GLUE

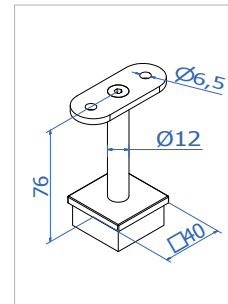

HR 410.00

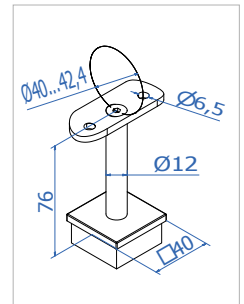

HR 410.42

Handrail bracket for the post 40x40x2



Code	Material	Saddle for handrail
HR510.00	316	Flat
HR510.42	316	Round Ø42.4

INFO: Use the glue HR.GLUE

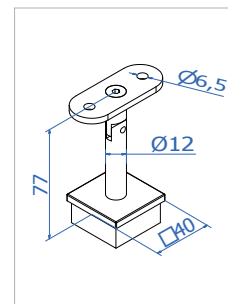

HR 510.00

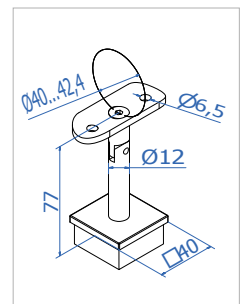

HR 510.42

Handrail bracket for the post 40x40x2



Code	Material	Saddle for handrail
HR610.00	316	Flat
HR610.42	316	Round Ø42.4

INFO: Use the glue HR.GLUE

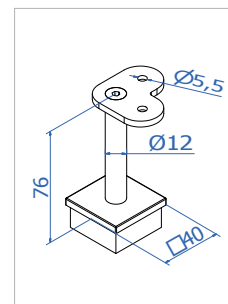

HR 610.00

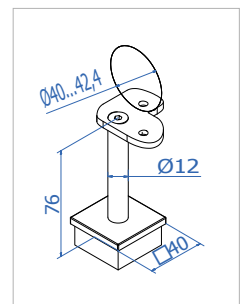

HR 610.42

Handrail bracket for the post 40x40x2



Code	Material	Saddle for handrail
HR710.00	316	Flat
HR710.42	316	Round Ø42.4

INFO: Use the glue HR.GLUE

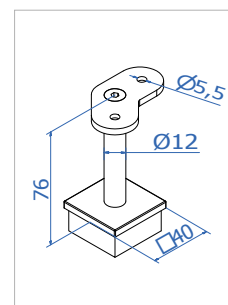

HR 710.00

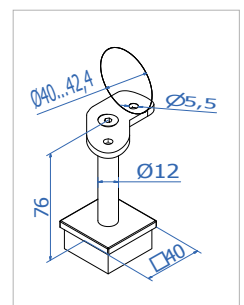

HR 710.42

Handrail accessories

Ø42.4x2 brushed pipe



Code	Material
TD424x2.304	304
TD424x2.316	316

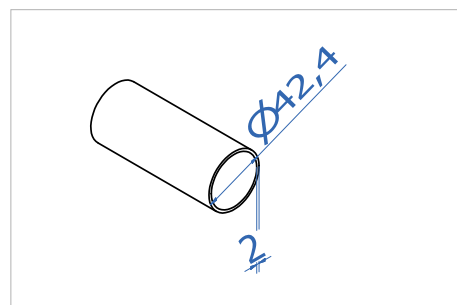

Ø42.4x2 pipe connector 180°



Code	Material
HRFA1120	316

INFO: Use the glue HR.GLUE

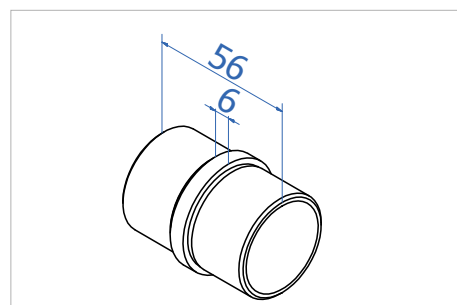

Ø42.4x2 pipe connector 90°



Code	Material
HRFA220	316

INFO: Use the glue HR.GLUE

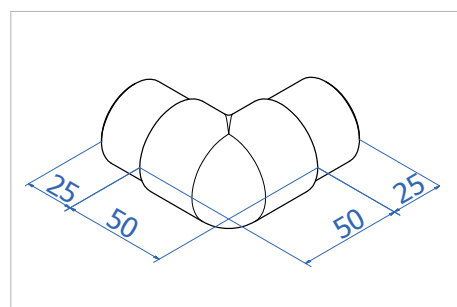

Ø42.4x2 pipe connector 135°



Code	Material
HRFA420	316

INFO: Use the glue HR.GLUE

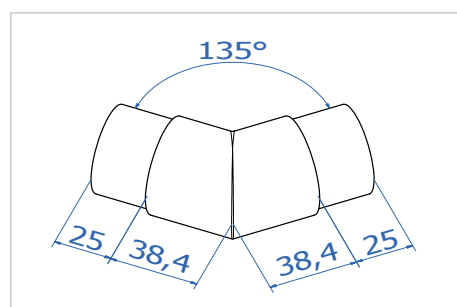

Handrail accessories

Ø42.4x2 pipe connector, adjustable



Code	Material
HRFAA920	316

INFO: Use the glue HR.GLUE

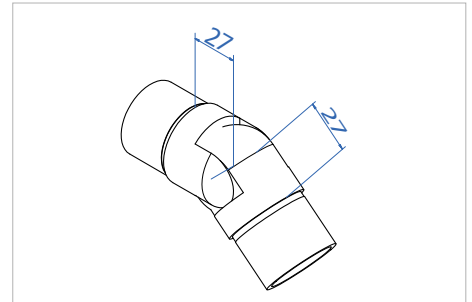

Ø42.4x2 pipe wall flange



Code	Material
HRBP400	316

INFO: The pipe is fixed with a retaining screw

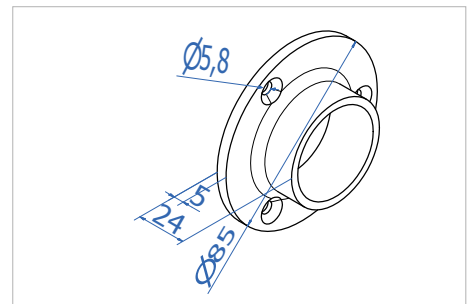

Ø42.4x2 pipe end cap



Code	Material
HRC220	316

INFO: Use the glue HR.GLUE

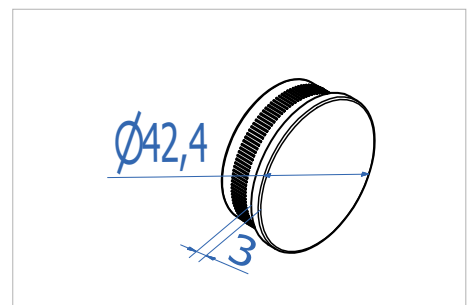

Ø42.4x2 pipe end cap with M8 thread



Code	Material
HRC220M8	316

INFO: Use the glue HR.GLUE

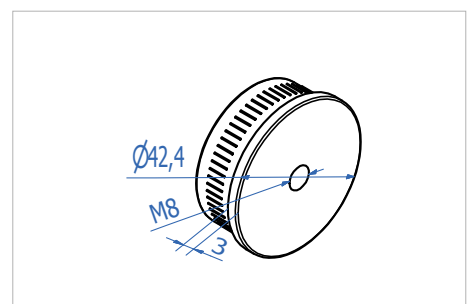

Handrail accessories

40x40x2 brushed pipe



Code	Material
T40402.304	304
T40402.316	316

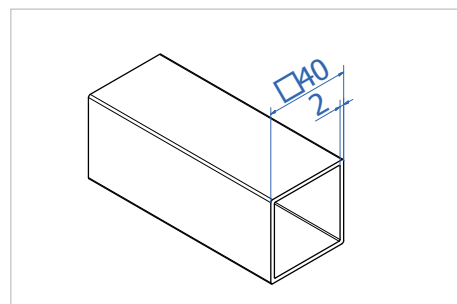

40x40x2 pipe connector 180°



Code	Material
HRST220	316

INFO: Use the glue HR.GLUE

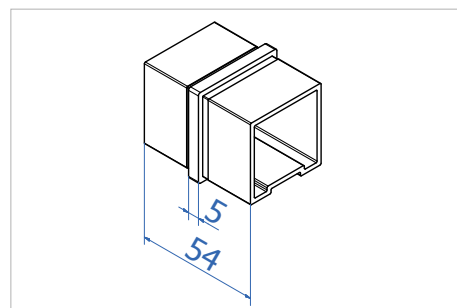

40x40x2 pipe connector 90°



Code	Material
HRST020	316

INFO: Use the glue HR.GLUE

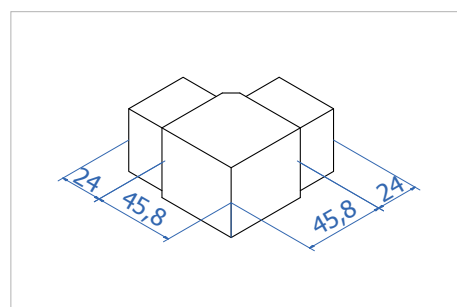

40x40x2 pipe connector, adjustable



Code	Material
HRST120	316

INFO: Use the glue HR.GLUE

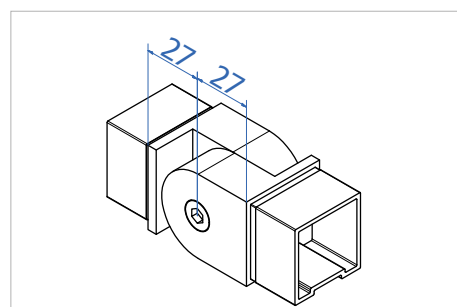

Handrail accessories

40x40x2 pipe wall flange



Code	Material
HRBP600	316

INFO: The pipe is fixed with a retaining screw

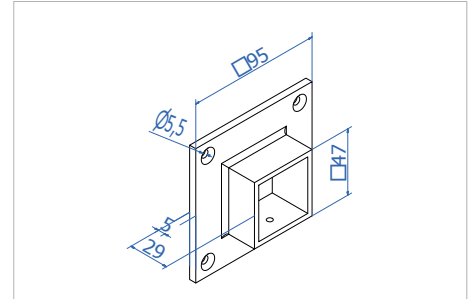

40x40x2 pipe end cap



Code	Material
HRC1220	316

INFO: Use the glue HR.GLUE

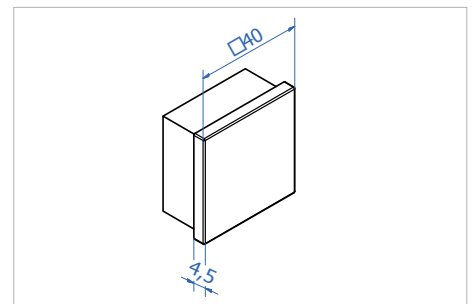

40x40x2 pipe end cap with M8 thread



Code	Material
HRC1320M8	316

INFO: Use the glue HR.GLUE

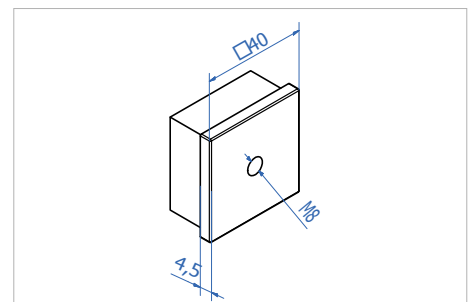

Accessories

Ø42.4 post base cover

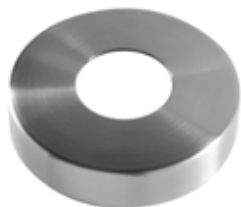

Code	Material
HRBC015	316

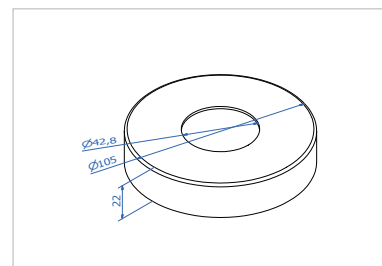

40x40 post base cover

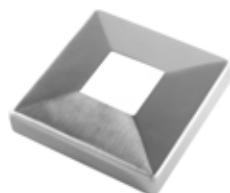

Code	Material
HRBC115	316

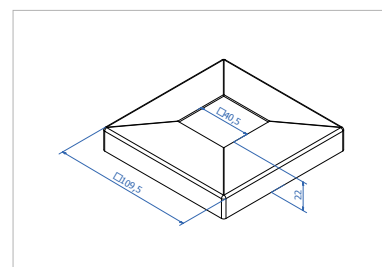

Stainless steel glue



Code	Quantity
HR.GLUE	50 ml

INFO: Sufficient for at least 50 glue joints

Cleaning and maintenance foam for stainless steel



Code	Quantity
HR.CLEAN	600 ml

INFO: Recommended to be used always after installation works

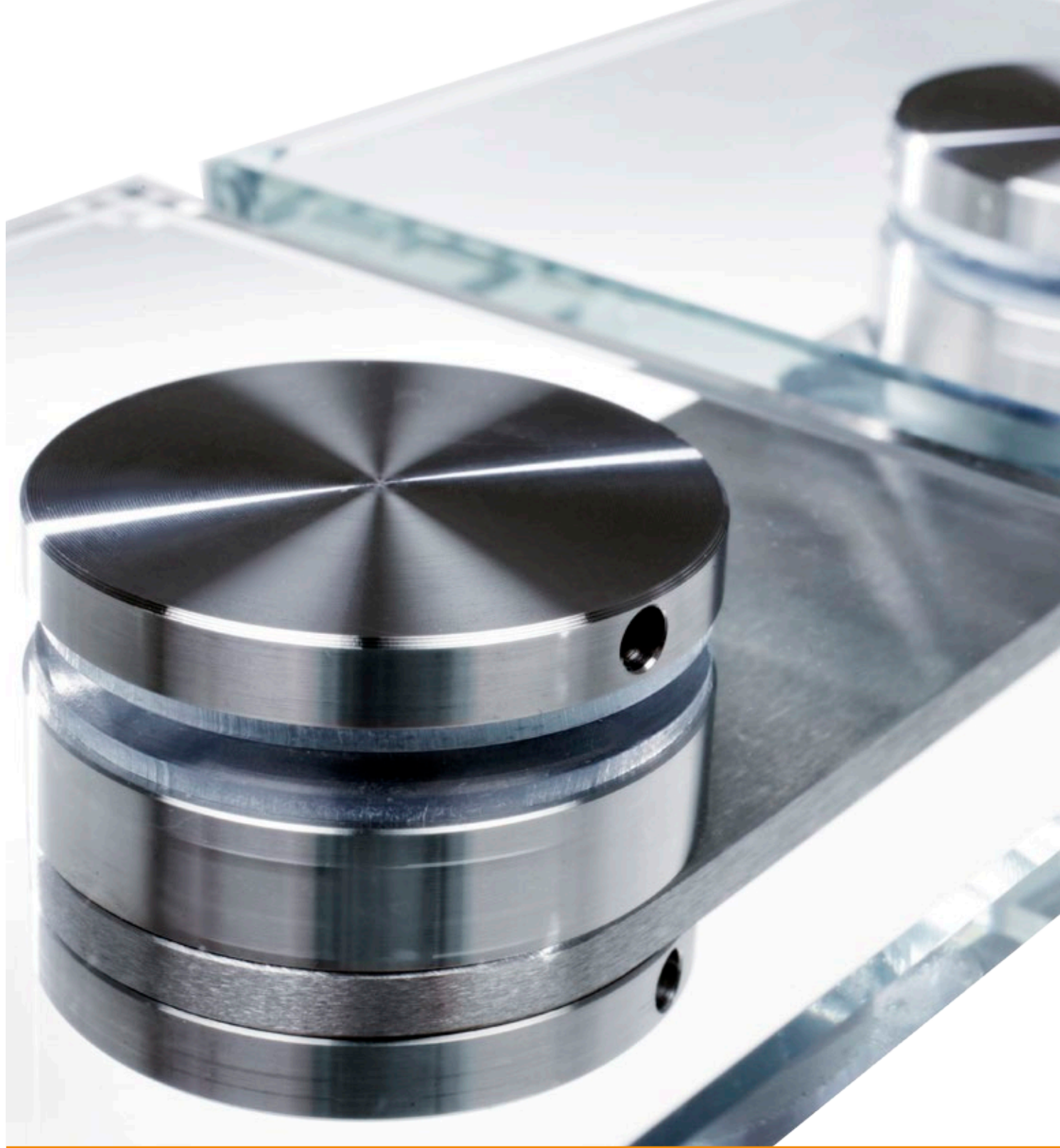

Point fixings for glass

Aesthetic and secure glass fixings



- Diameters of standard models 16–60 mm
- Flexible configurations according to your needs
- Flush- and surface-mounted models
- For all thicknesses of glass
- Tested load-bearing capacities
- All elements are machine-processed
- Material **304** (EN 1.4301) or **316** (EN 1.4404)

Surface-mounted point fixings

R-Point 16



- Material:** 304
PVC gaskets
- Bolt:** KP16.01 – M5x40 Zn
KP16.02 – M5x40 Zn wood bolt
- Suitable spanner:** Hexagonal spanner 1.5 mm

KP16.01 / KP16.02

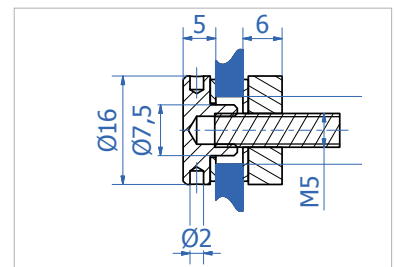

R-Point 30



- Material:** KP30.01 – 304
KP30.51 – 316
- Bolt:** PVC gaskets
M8 (not supplied)
- Suitable spanner:** Hook spanner KP99.01

KP30.01 / KP30.51

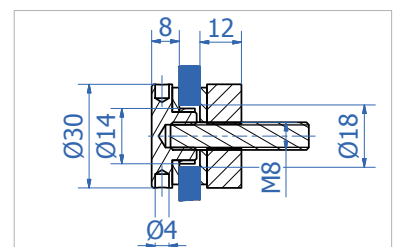

INFO: threaded spacer

R-Point 30, only head



- Material:** KP30.11 – 304
KP30.61 – 316
- Bolt:** PVC gaskets
M8 (not supplied)
- Suitable spanner:** Hook spanner KP99.01

KP30.11 / KP30.61

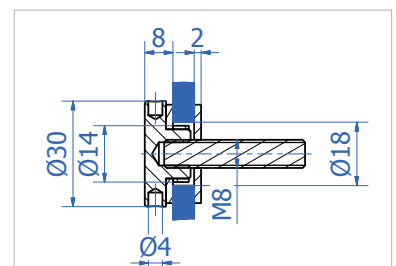

Surface-mounted point fixings

R-Point 45

KP45.01 / KP45.51



Material:	KP45.01 – 304	
	KP45.51 – 316	
	PVC gaskets	
Bolt:	M10 (not supplied)	
Suitable spanner:	Hook spanner KP99.02	
Load-bearing capacity:	Axial	8 kN
	Radial	4 kN

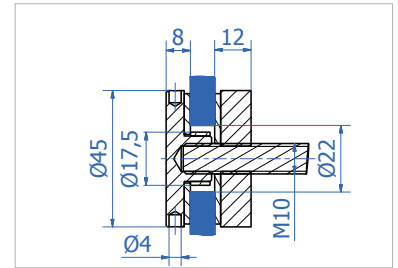

INFO: threaded spacer

R-Point 45, distance 27 mm

KP45.02 / KP45.52



Material:	KP45.02 – 304	
	KP45.52 – 316	
	PVC gaskets	
Bolt:	M10 (not supplied)	
Suitable spanner:	Hook spanner KP99.02	
Load-bearing capacity:	Axial	8 kN
	Radial	4 kN

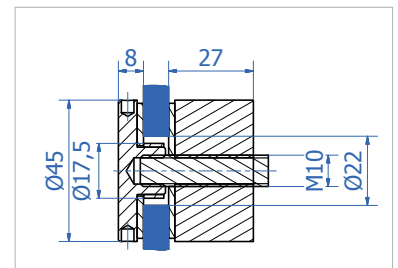

INFO: threaded spacer

R-Point 45, head only

KP45.11 / KP45.61



Material:	KP45.11 – 304	
	KP45.61 – 316	
	PVC gaskets	
Bolt:	M10 (not supplied)	
Suitable spanner:	Hook spanner KP99.02	
Load-bearing capacity:	Axial	8 kN
	Radial	4 kN

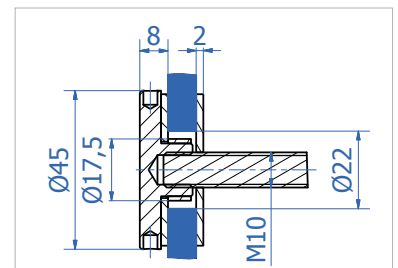

Bracket for using between glass panes

KP45.21 / KP45.71

KP45.22 / KP45.72



Product code	Material	Glass thickness
KP45.21	304	6-10 mm
KP45.22	304	12-13.5 mm
KP45.71	316	6-10 mm
KP45.72	316	12-13.5 mm

+ PVC gaskets

Suitable spanner: Hook spanner KP99.02

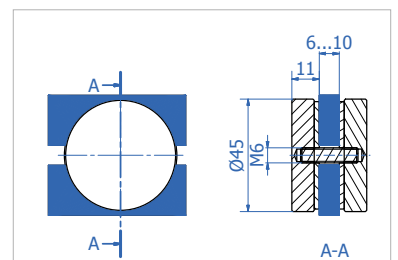

Point fixings for glass

Surface-mounted point fixings

R-Point 60

KP60.01 / KP60.51



Material:	KP60.01 – 304	
	KP60.51 – 316	
	PVC gaskets	
Bolt:	M12 (not supplied)	
Suitable spanner:	Hook spanner KP99.02	
Load-bearing capacity:	Axial	12 kN
	Radial	6 kN

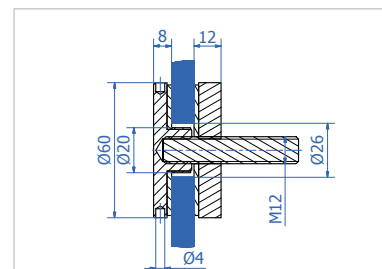

INFO: threaded spacer

R-Point 60, only head

KP60.11 / KP60.61



Material:	KP60.11 – 304	
	KP60.61 – 316	
	PVC gaskets	
Bolt:	M12 (not supplied)	
Suitable spanner:	Hook spanner KP99.02	
Load-bearing capacity:	Axial	12 kN
	Radial	6 kN

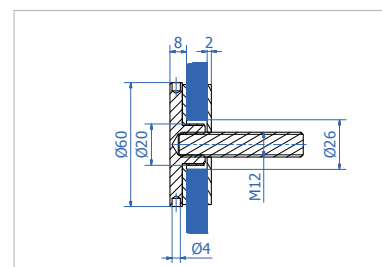

R-Square

KP50.50/KP50.55



Material:	KP50.50 – 304	
	KP50.55 – 316	
	PVC gaskets	
Bolt:	M10 (not supplied)	
Suitable spanner:	Fork spanner KP99.03	
Load-bearing capacity:	Axial	8 kN
	Radial	4 kN

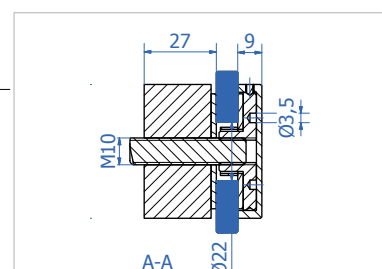
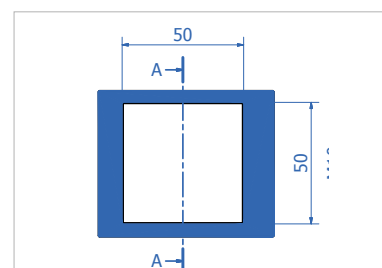

Stud bolts, wood bolts



Material:	A2 304 A4 316
Diameters:	M8 (R-Point 30) M10 (R-Point 45, R-Square) M12 (R-Point 60)
Lengths:	L= 30, 40, 60, 80, 120

Point fixings with adjustable spacer

Adjustable Ø35, surface-mounted

KP35R.51



Material:	316
	POM gaskets
Spacer:	15–18 mm
Glass thickness:	8–13,52 mm
Bolt:	M8 DIN 6912 (not supplied)
Suitable spanner:	Fork spanner KP99.03

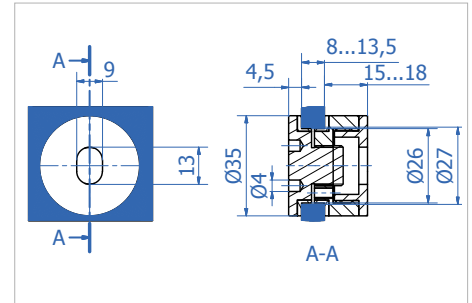

INFO: Adjustable sideways +/- 2.5 mm

Adjustable Ø35, flush-mounted

KP35R.52



Material:	316
	POM gaskets
Spacer:	15–18 mm
Glass thickness:	8–13,52 mm
Bolt:	M8 DIN 6912 (not supplied)
Suitable spanner:	Fork spanner KP99.03

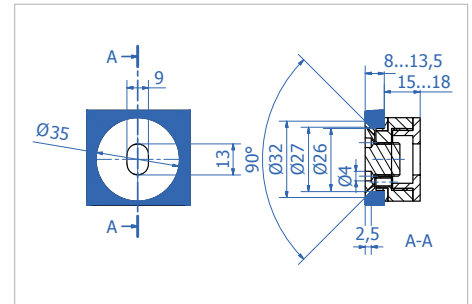

INFO: Adjustable sideways +/- 2.5 mm

Adjustable Ø50, surface-mounted

KP50R.51



Material:	316
	POM gaskets
Spacer:	20–25 mm
Glass thickness:	10–17,52 mm
Bolt:	M10 DIN 6912 (not supplied)
Suitable spanner:	Hook spanner KP99.02

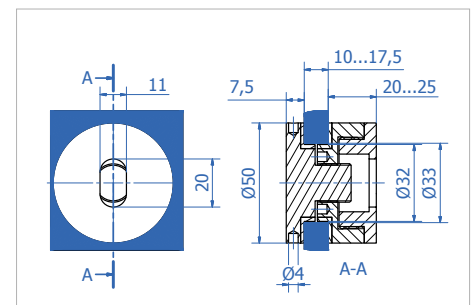

INFO: Adjustable sideways +/- 5 mm

Adjustable Ø50, flush-mounted

KP50R.52



Material:	316
	POM gaskets
Spacer:	20–25 mm
Glass thickness:	10–17,52 mm
Bolt:	M10 DIN 6912 (not supplied)
Suitable spanner:	Fork spanner KP99.03

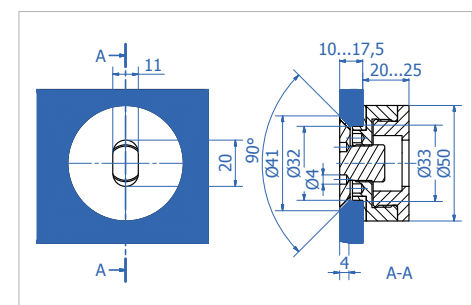

INFO: Adjustable sideways +/- 5 mm

Point fixings for glass

Flush-mounted point fixings for thick glass

Point fixing for glass stairs



Material: 316
POM+PVC gaskets

Glass thickness: 10 + 10 + 10

Bolt: M10 (not supplied)

Suitable spanner: Fork spanner KP99.03

KP.STR33

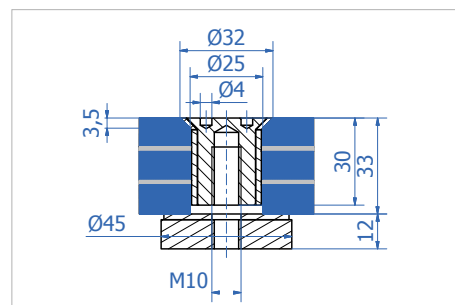

Point fixing for glass stairs



Material: 316
POM+PVC gaskets

Glass thickness: 10 + 10

Bolt: M10 (not supplied)

Suitable spanner: Fork spanner KP99.03

KP.STR21

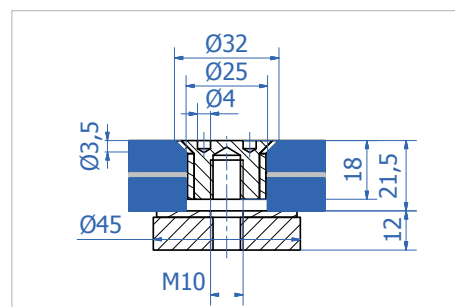

Flush-mounted point fixings for 8 + 8 glass



Material: 316
POM gaskets

Glass thickness: 8 + 8

Bolt: M10 (not supplied)

Suitable spanner: Fork spanner KP99.03

KP.STR17

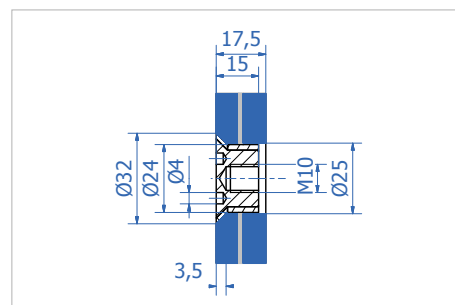

Glass pane connectors

Ø30 connector glass-glass, 180°

KP90.11



- Material:** 304
PVC gaskets
- Glass thickness:** To be specified when submitting the order
- Suitable spanner:** Hook spanner KP99.01

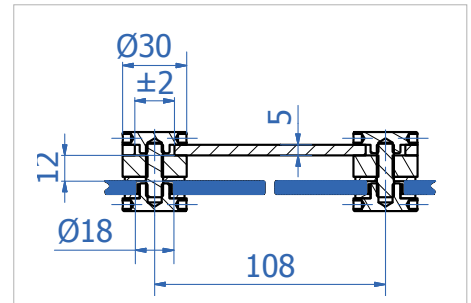

Ø30 connector glass-glass, 90°

KP90.12



- Material:** 304
PVC gaskets
- Glass thickness:** To be specified when submitting the order
- Suitable spanner:** Hook spanner KP99.01

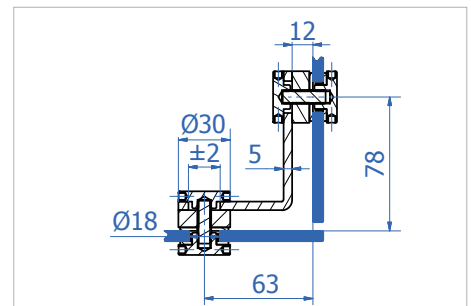

Ø30 connector glass-wall, 90°

KP90.13

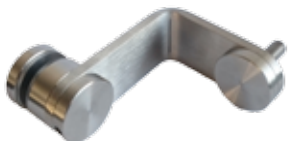

- Material:** 304
PVC gaskets
- Glass thickness:** To be specified when submitting the order
- Suitable spanner:** Hook spanner KP99.01

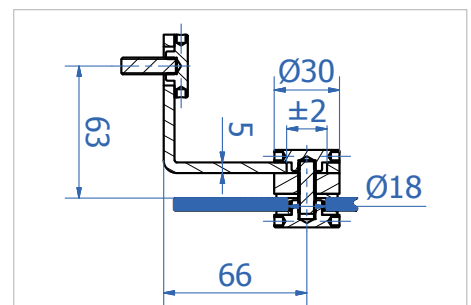

Ø45 connector glass-glass, 180°

KP90.21



- Material:** 304
PVC gaskets
- Glass thickness:** To be specified when submitting the order
- Suitable spanner:** Hook spanner KP99.02

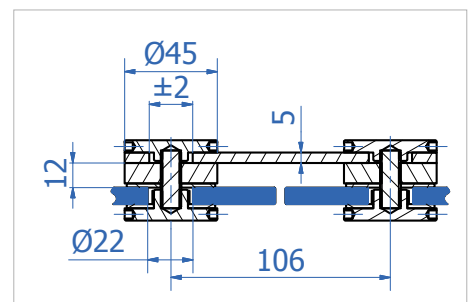

Glass pane connectors

Ø45 connector glass-glass, 90°

KP90.22



- Material:** 304
PVC gaskets
- Glass thickness:** To be specified when submitting the order
- Suitable spanner:** Hook spanner KP99.02

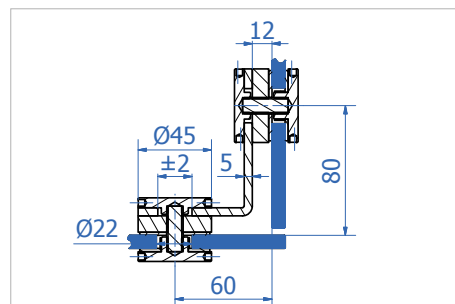

Ø45 connector glass-wall, 90°

KP90.23

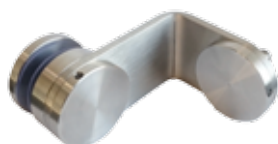

- Material:** 304
PVC gaskets
- Glass thickness:** To be specified when submitting the order
- Suitable spanner:** Hook spanner KP99.02

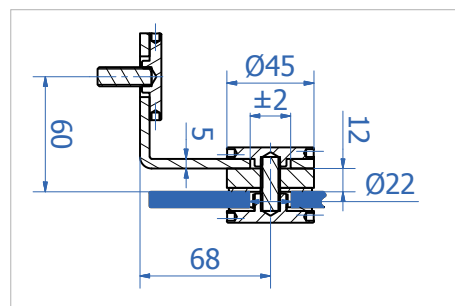

Ø45 spider connector

KP90.24



- Material:** 304
PVC gaskets
- Glass thickness:** To be specified when submitting the order
- Suitable spanner:** Hook spanner KP99.02

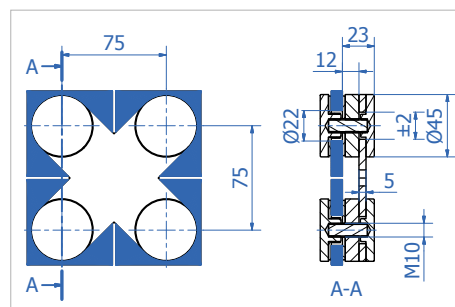

Spanners for point fixings

- 1 Hook spanner for point fixings, Ø20–35 KP99.01
- 2 Hook spanner for point fixings, Ø35–60 KP99.02
- 3 Fork spanner for point fixings KP99.03



KP99.01



KP99.02



KP99.03



Glass canopy system RC

Aesthetic and durable glass canopy



- The load-bearing capacity of the system meets the requirements of the Nordic climate.
- The system can be adjusted to the roofs with custom measures.
- Can be used with heat strengthened laminated safety glass.
- Glass thicknesses: 88.4 (17.5 mm), 1010.4 (21.5 mm), 1212.4 (24.5 mm).
- Standard depths of the glass from the wall 800-2000 mm.
- All elements are machine-processed.
- The material used is stainless steel 316 (EN 1.4404)

RC1 – For attaching the glass on the wall

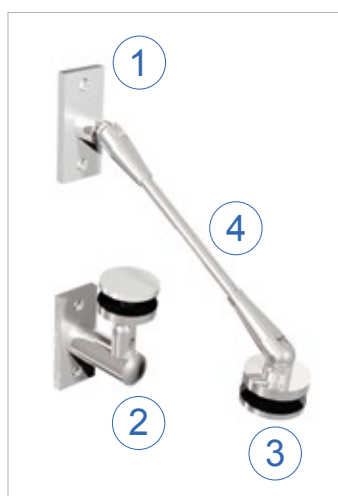

System components:

- 1 x upper wall fastener
- 1 x lower wall fastener
- 2 x glass point-fixing system
- 1 x tension rod (lengths as per the type)

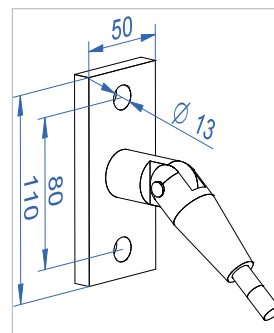

For fastening on the wall M12 A4 bolts are used.

RC2 – For attaching the glass on the mounting plates

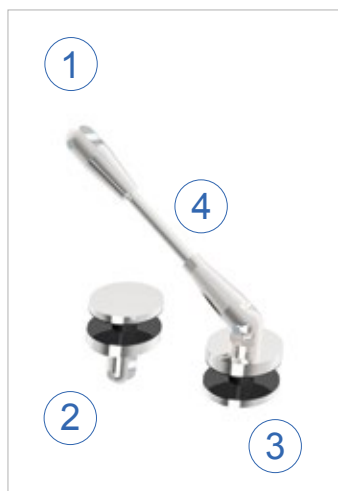

System components:

- 1 x upper fastening yoke
- 1 x lower fastening yoke
- 2 x glass point-fixing system
- 1 x tension rod (lengths according to the type)

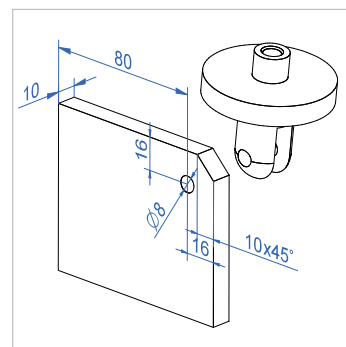
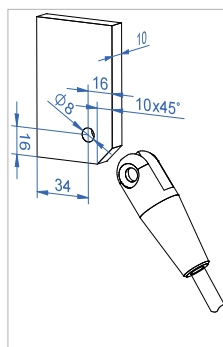

The system is attached to the plates with M8 bolts (included in the set)

System dimensions RC1

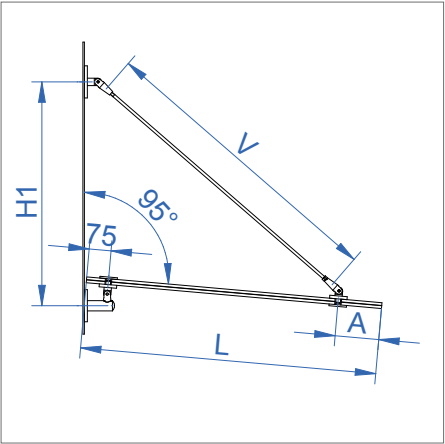

L, mm	H1 (RC1)	V	A	H2 (RC2)	T min
800	660	745	200	610	8+8
900	530	745	200	480	8+8
1000	790	995	200	750	8+8
1100	790	995	300	750	8+8
1200	670	995	300	620	8+8
1300	1240	1475	300	1200	8+8
1400	1140	1475	300	1100	8+8
1500	1040	1475	300	990	10+10
1600	970	1475	350	920	10+10
1700	1570	1975	350	1530	10+10
1800	1470	1975	350	1430	10+10
1900	1360	1975	350	1320	10+10
2000	1240	1975	350	1190	10+10

System dimensions RC2

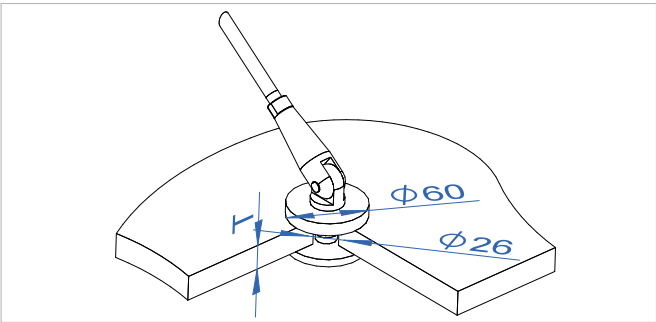
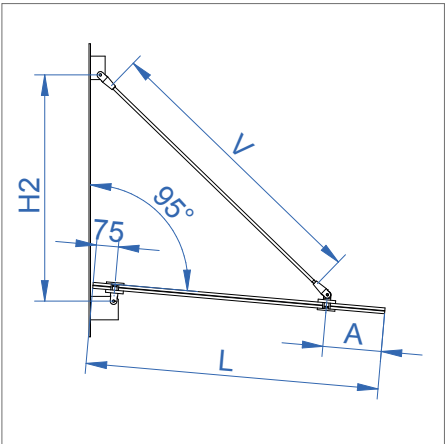

Opening in the glass

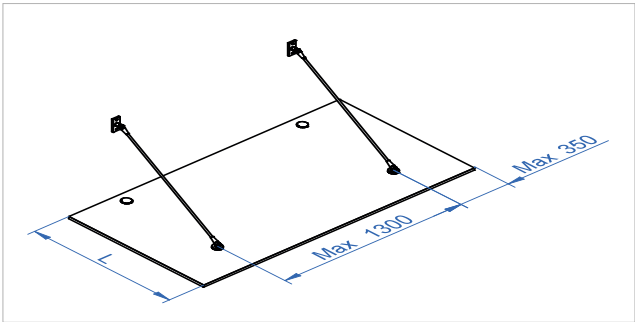

Max. pitch of holders

RC3 – Bottom-supported glass canopy system



RC3 is meant to be used with smaller glass canopies in places where it is not possible to use tension rods.



System components:

- 1 1 x lower glass holder
- 2 2 x glass point-fixing system

For fastening on the wall M12 A4 bolts are used. Recommended glass: 66.4 tempered/laminated

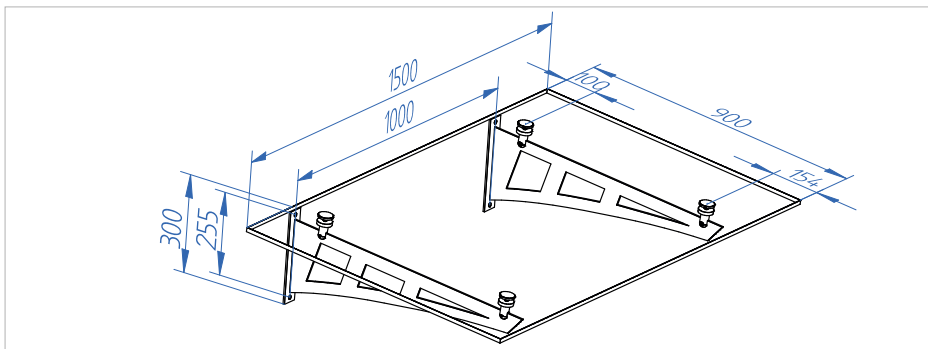

Max. pitch of holders for RC3 glass canopy is 1000 mm. Standard glass dimensions 1500 x 900 mm

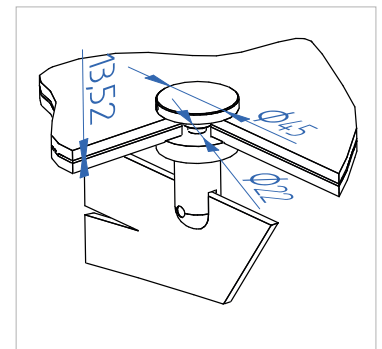

Opening in the glass



Tension rod system TR

Aesthetical and safe solution



- CE-certified
- Material: stainless steel 304 (EN 1.4301) or 316 (EN 1.4404)
- Aesthetic design
- 100% CNC-machined
- Rod diameter: M6–M36
- Load-bearing capacity: 6,3 – 262 kN
- Can be installed with standard tools
- Compression rods available



System components

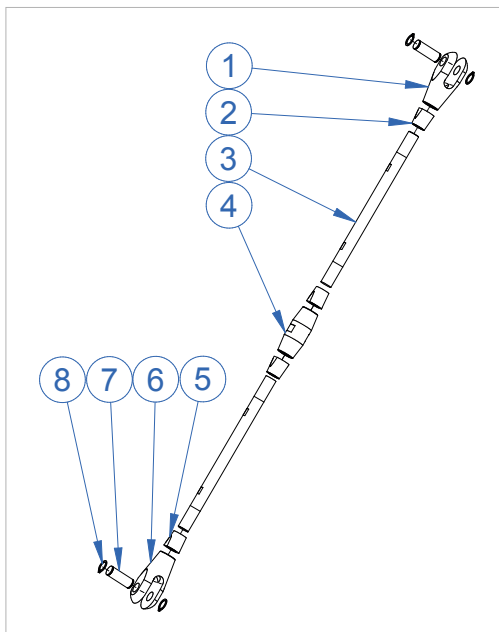

- 1 End-fork, right-hand thread
- 2 Locknut, right-hand thread
- 3 Tension rod
- 4 Connection sleeve
- 5 Locknut, left-hand thread
- 6 End-fork, left-hand thread
- 7 Shear pin
- 8 Locking ring
- 9 Anchor plate

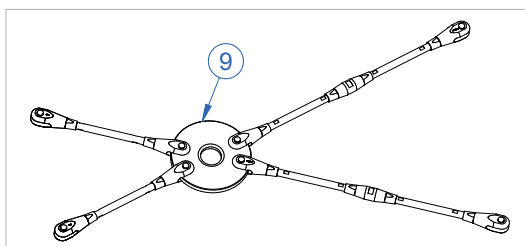

Standard systems

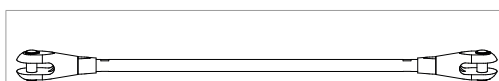

1 System with one rod – TR1



2 System with a connection sleeve and two rods – TR2

Rods and load-bearing capacity

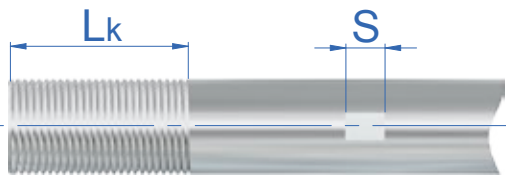

Dnom	6	8	10	12	16	20	24	27	30	36
F	6.3	11.5	18	26	50	78	112	147	179	262
Lk	20	22	29	37	43	52	63	70	74	88
S	10	10	10	10	16	16	16	20	20	20
V	5	7	9	10	14	18	21	24	27	32

F – system bearing capacity (kN)

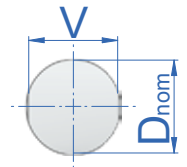

End forks

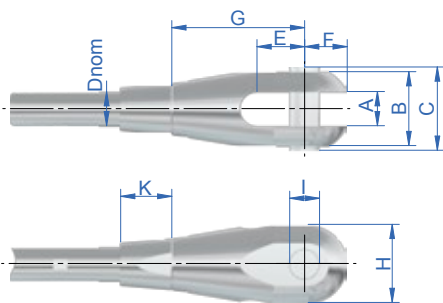

Dnom	6	8	10	12	16	20	24	27	30	36
A	6	8	10	12	16	20	22	25	30	32
B	14	20	26	30	36	42	52	56	64	84
C	19	26	32	36	42	48	58	62	71	91
E	9	12	15	18	24	29	35	39	43	50
F	8	11	14	17.5	22.5	27.5	30	32.5	35	44
G	30	34	42	51	63	79	94	107	112	132
H	15.5	20.5	26	33	42	51	55	59	63	84
I	5	7	9	12	14	18	21	24	26	30
K	13	13	18	23	25	30	36	40	41	48

Connection sleeve

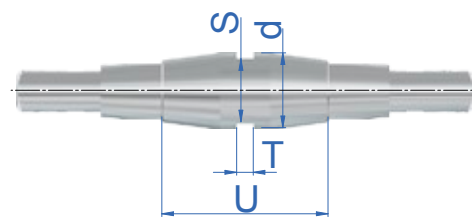

Dnom	6	8	10	12	16	20	24	27	30	36
U	37	39	51	62	75	100	106	119	122	141
d	14	16	18	20	28	35	45	45	55	65
S	13	14	17	17	24	32	38	41	50	54
T	10	10	10	10	16	16	16	20	20	20

Cross coupler

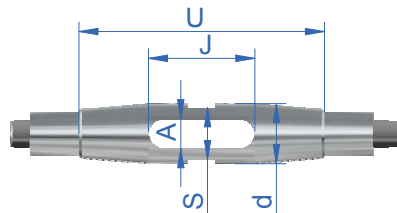
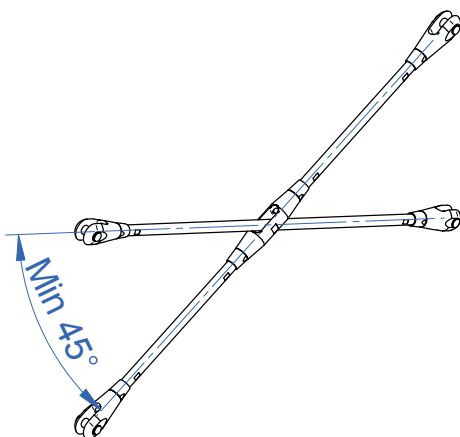

Dnom	6	8	10	12	16	20	24	27	30	36
U	67	75	90	108	132	161	195	216	225	271
d	18	20	22	25	35	45	55	60	60	75
S	14	17	19	22	29	41	46	50	54	65
J	29	33	39	45	61	77	93	104	107	131
A	7	9	11	13	17	21	25	29	31	37

Tension rod system TR

TR1 system length



Dnom	6	8	10	12	16	20	24	27	30	36
Nmin	126	134	166	202	242	290	340	386	398	460
P	10	10	13	17	17	20	24	26	26	30

TR2 system length

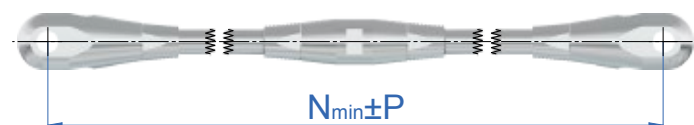

Dnom	6	8	10	12	16	20	24	27	30	36
Nmin	229	239	299	364	433	522	598	677	694	797
P	20	20	26	34	34	40	48	52	52	60

Anchor plates

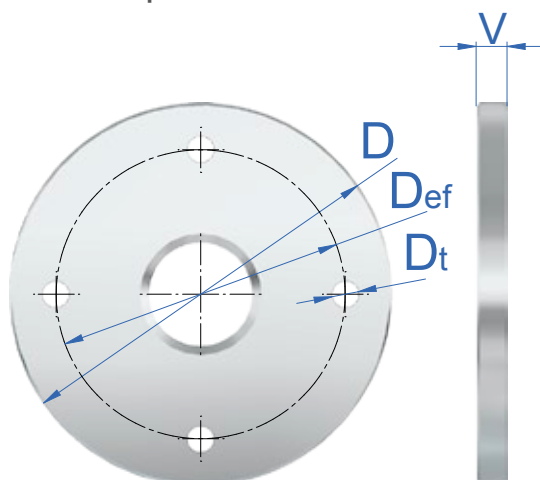

Dnom	6	8	10	12	16	20	24	27	30	36
D	72	96	120	138	184	234	274	308	338	408
Def	56	74	92	104	138	178	206	232	254	310
Dt	5.2	7.2	9.2	12.2	14.2	18.2	21.2	24.2	26.2	30.2
E	9	12	15	18	24	29	35	39	43	50
V*	6	8	10	12	16	20	22	25	30	32

Minimum angle between holes 45°; max. 8 holes on a disc

* Includes the thickness of the paint coating

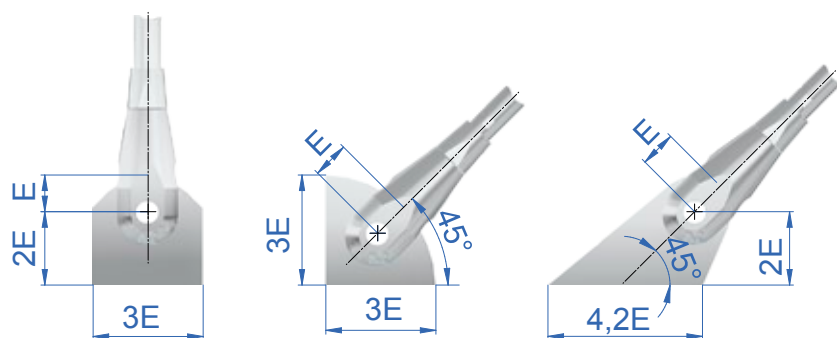

The strength of the anchor plates corresponds to grade S355 steel



Point fixed SG-facade

Aesthetical and safe solution

- Maximum transparency of the glass facade thanks to the absence of frames
- Both single glasses and insulated glass units can be used
- Bearing glass fins ensure the full transparency of the facade
- Stainless steel material 316 is durable in all conditions



Estonian National Museum, Tartu - point fixings of the facade

The point fixed glass facade presupposes a project specific approach from the constructor, because the wind loads that affect the facade and the glass dimensions are always different. Depending on the wind load, the correct thicknesses of glasses should be dimensioned. The dead weight of glass is dependent on that. The selection of correct fixing accessories is based on the wind load and the dead weight of the glass.



Otaniemi subway station, Helsinki – strength analysis of the façade with glass fins, and fixing accessories

R-FIX helps you to create original and secure point fixed glass facades by providing a full service from the performance of strength analyses to the manufacturing of fixing accessories. The catalogue gives a short overview about the glass facade fixing accessories offered by R-FIX. As each project is different, we have a large selection of project-specific accessories with special designs. For additional information, please contact.

Facade point fixings

Swivel point fixing



Product code	SG0101	SG0102
Glass thickness T	8-18 mm	18-26 mm
Dimension A	28 mm	36 mm
Axial load bearing capacity (wind load)	4.5 kN	4.5 kN
Radial load bearing capacity (glass dead weight)	2 kN	2 kN
Glass tensioning	From the bolt side	From the bolt side

INFO: It is possible to manufacture different modifications depending on the project requirements

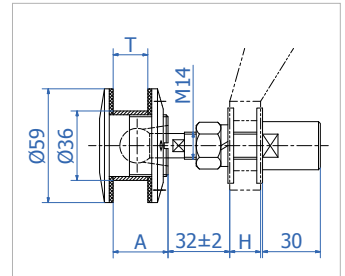

Swivel point fixing, flush mounted



Product code	SG0111
Axial load bearing capacity (wind load)	4.5 kN
Radial load bearing capacity (glass dead weight)	2 kN

INFO: It is possible to manufacture different modifications depending on the project requirements

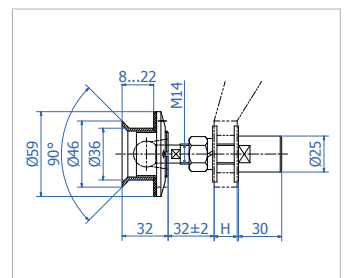

Swivel point fixing, bearing the inner glass of the insulated glass unit



Product code	SG0121
Glass thickness T	13.52 / 17.52 mm
Axial load bearing capacity (wind load)	4.5 kN
Radial load bearing capacity (glass dead weight)	2 kN
Glass tensioning	From the bolt side

INFO: It is possible to manufacture different modifications depending on the project requirements

Suitable for installation on the insulated glass unit production line

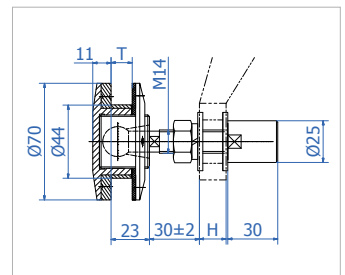

Swivel point fixing, penetrating the insulated glass unit



Product code	SG0122
Axial load bearing capacity (wind load)	6 kN
Radial load bearing capacity (glass dead weight)	2.5 kN
Glass tensioning	From the bolt side

INFO: It is possible to manufacture different modifications depending on the project requirements

The selection includes aluminium rings of different thickness for sealing the insulated glass unit

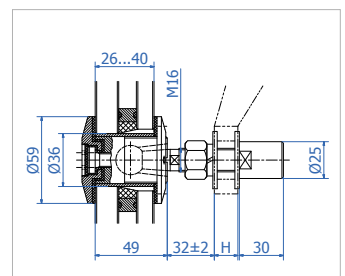

Swivel point fixing, laminated into the glass



Product code	SG0131
Glass thickness T	≥10mm
Axial load bearing capacity (wind load)	4.5 kN
Radial load bearing capacity (glass dead weight)	2 kN
Glass tensioning	From the bolt side

INFO: It is possible to manufacture different modifications depending on the project requirements

Suitable for installation on a glass lamination line

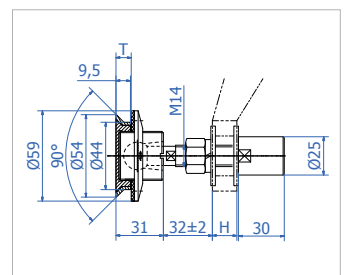

Spider-fittings

Spider-fitting for 4 point fixings, diagonal



Product code	SG0201
Axial load bearing capacity of one leg (wind load)	2 kN
Radial load bearing capacity of one leg (glass dead weight)	1 kN

INFO: It is possible to manufacture different modifications depending on the project requirements

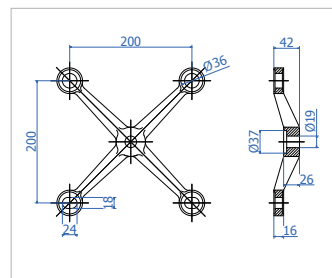

Spider-fitting for 2 point fixings, diagonal



Product code	SG0202
Axial load bearing capacity of one leg (wind load)	2 kN
Radial load bearing capacity of one leg (glass dead weight)	1 kN

INFO: It is possible to manufacture different modifications depending on the project requirements

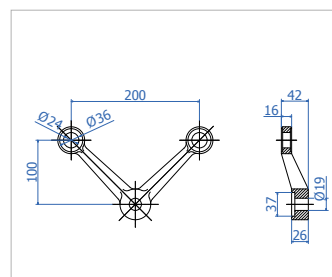

Spider-fitting for 2 point fixings, parallel



Product code	SG0203
Axial load bearing capacity of one leg (wind load)	2 kN
Radial load bearing capacity of one leg (glass dead weight)	1 kN

INFO: It is possible to manufacture different modifications depending on the project requirements

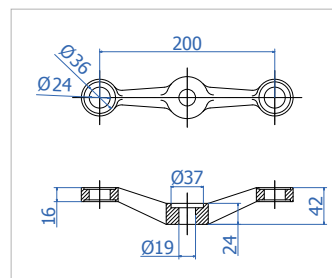

Spider-fitting for 1 point fixing, diagonal



Product code	SG0204
Axial load bearing capacity of one leg (wind load)	2 kN
Radial load bearing capacity of one leg (glass dead weight)	1 kN

INFO: It is possible to manufacture different modifications depending on the project requirements

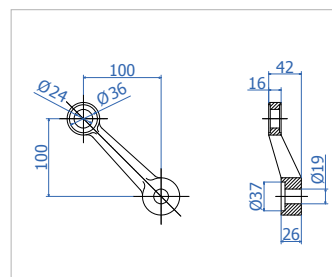

Spider-fitting for 1 point fixing, parallel



Product code	SG0205
Axial load bearing capacity of one leg (wind load)	2 kN
Radial load bearing capacity of one leg (glass dead weight)	1 kN

INFO: It is possible to manufacture different modifications depending on the project requirements

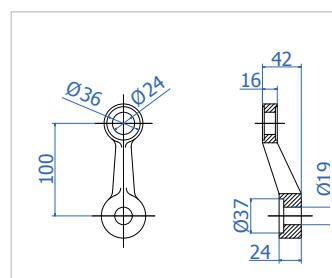



Astri Shopping Centre, Narva – facade point fixings and spider-fittings



Solna parking house, Stockholm – facade point fixings



www.rfix.eu